



WHAT THEY SAY...

- **RESIDENT:** "I'm 100% happy, The staff are very friendly. Meals are perfect. I wouldn't want to live anywhere else." A.L.
- **STAFF:** "I love working at Chester Village because everyone works together and respects each other. Residents can feel our love and caring because we are not so big." G.M.
- **DAUGHTER:** "Thoughtfully planned meals, special events, a kind word here, a hug there, ...are all things which keep the residents feeling they are still part of a vibrant community." L.R.

MEANINGFUL LIVING...



Our Meaningful Living philosophy has evolved from our strong desire to provide each special resident with a life affirming, homelike and caring environment. We constantly strive to create opportunities for residents to direct their own choices in fun and meaningful ways.

Two excellent examples would be our **Intergenerational Program** with local schoolchildren and our constant emphasis on relationships between, **People, Plants and Pets.**

WHAT'S NEW AT CHESTER VILLAGE ?

**Welcome to MEANINGFUL LIVING...
... where life has meaning.**

In our new residence, we offer a varied program of leisure activities for our residents to direct their own life choices in fun and meaningful ways.

In keeping with the on-going needs for flexibility and combined options for long-term care (LTC), Chester Village provides all of the modern requirements necessary to address comprehensive security, nursing and social support for all residents.



Our beautiful, spacious central lobby has a gift shop, a café, a barber/beauty salon, a craft room, the Volunteer/Resident Council office and a Client Service Centre with a bank and a post office. This "Town Square" design affords all residents ample opportunity to participate actively in the life of the residence or simply to sit and watch the daily comings and goings.

Since meals are often the highlight of the day, the dining areas on each floor are open, comfortable spaces where the nursing staff help residents to feel they belong in this important social aspect of residence life. All of these areas have both north and south views.

There are 7 distinct 29 bed Resident Home Areas (RHAs) on the 4 floors and each of the second, third and fourth floors has a spacious, secure, plexiglass-enclosed balcony overlooking the garden and outdoor areas. Residents can choose to relax and enjoy the view or participate in organized activities. Each RHA is named after a **gemstone**, each one as precious as every individual resident. (Diamond, Topaz, Sapphire, Jade, Ruby, Amethyst and Emerald).

One of our RHAs (Jade), is specifically intended for members of our Chinese community, offering Chinese cuisine and other culturally specific needs.



From the ground floor there is easy access to green space for all residents. Our secure, enclosed "Enchanted Garden" is a quiet oasis on the south side with shaded seating areas, level walkways, flowers and elevated planters for residents in wheelchairs.

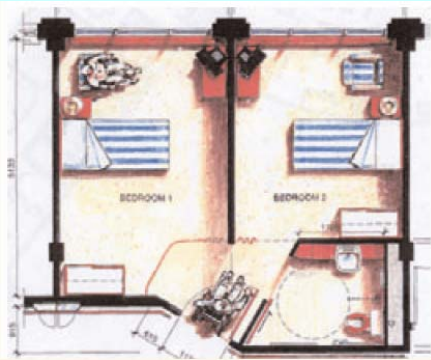

ARCHITECTURAL DESIGN & DELUXE SUITES

Our new Chester Village is a state-of-the-art facility. It is designed under the Ministry of Health new Long-Term Care guidelines. The architectural design articulates the many needs of residents requiring Long-Term Care. Our architects, Sievenpiper Associates, have frequently been honored with Awards of Excellence. There are spacious Semi-private and Private single rooms available. The double "Semi-private" rooms can be adapted into preferred accommodation "Deluxe Suites" for couples, with one room being the bedroom and the other becoming the sitting room. These are available on a priority, first come-first served basis. Palliative and specialized care are also possible here since these rooms are larger than the others.

TO BOOK A TOUR OF OUR FACILITY CONTACT: Social Services Coordinator – 416-466-2173 ext. 251



WHY VOLUNTEER ?

Chester Village needs volunteers.... why not join us to help others. You will enjoy the many wonderful benefits and opportunities that we can offer, to work with seniors and give something back to your community, while you get valuable work experience, meet new people and make new friends.



WHY DONATE ?



Volunteers play an important, integral role by enriching the lives of our residents in meaningful ways. There are placement positions for all students of all cultures from high schools, colleges and universities. If you are caring and compassionate as well as energetic and enthusiastic, then we want you.

You will be working with dedicated, professional co-workers in a meaningful and fulfilling team-oriented atmosphere, with excellent opportunities for personal and professional development and growth.

We Offer:

- An opportunity to Explore, Evolve and Enjoy
- Extensive training and ongoing educational support
- Meaningful placement in our facility and a positive experience in your role
- To strive to match resident needs with volunteer interests

We Require:

- A 6 month commitment, TB test and a Flu shot. A Police check is mandatory for those 18 years and older
- Volunteer opportunities include friendly visits, facilitating activities, taking care of pets and plants, clerical support, feeding assistance, working in the Relaxing Café and Village Shoppe, helping with special events and outings, reading to a resident and personal shopping for residents.

Contact: Life Enrichment Services

Volunteer Coordinator – 416-466-2173, ext. 110

We are a not-for-profit charitable organization and have volunteers who donate their valuable time. However, we do need generous donors like you to contribute much-needed and much-appreciated funds which will enable us to continue our valuable work with our community seniors.

We encourage you to help us to care for these valuable members of our society as well as they deserve.

CHARITABLE TAX REG # 11881 9317 RR0001

TAX TIPS

Rent paid to Chester: Income Tax savings from the medical expense claim, means that your net rent may be less than you think.

Charitable Donations: In Canada, your first \$200 qualifies for a 17% federal tax credit (23.4% federal/provincial combined). After \$200, you will get a credit of 29% (36% federal/provincial combined). So, charitable contributions offer you some significant tax savings. <http://www.canadahelps.org/> or call us: 416-466-2173

